

## SMA <sup>Ⓜ</sup>

### Spring Mount

(Deflection : 25mm)

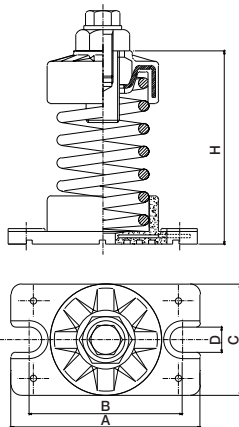

#### ● Features

An open-spring mount is, in general, used together with the additional load base. It is easy to install and check; also its static deflection is visible to the naked eye. The spring is in between the upper cap and the bottom cap without any guide, and the bottom cap is mounted with the base plate having a hole for the anchor bolt. Plus, the steel plate is inserted inside the cap and at the top of the mount, there is a level-control bolt made up of the control bolt, cap, screw and washer. There is also a drain hole inside the bottom base, which facilitates drainage.

- Usage - For pump vibration isolator stand
- For ventilator
- For air conditioning units
- For equipment having a small horizontal reaction

#### ● Dimension & Selection Guide

Type	Capacity (kgf)	Spring Constant (kgf/mm)	Weight (kg)	Color	Dimension(mm)						
					A	B	C	D	H	Level Blot	Cap Screw
SMA-A-50	50	2.0	0.35	Red	90	74	53	12	94	M16×45	M10×25
SMA-A-75	75	3.0	0.39	Black							
SMA-A-100	100	4.0	0.41	Blue							
SMA-B-100	100	4.0	1.10	Blue	130	100	70	13	128	M20×90	M12×25
SMA-B-150	150	6.0	1.12	Brown							
SMA-B-200	200	8.0	1.18	White							
SMA-B-300	300	12.0	1.34	Orange							
SMA-B-400	400	16.0	1.34	Pink							
SMA-C-400	400	16.0	1.90	Pink	150	120	84	13	144	M20×90	M12×25
SMA-C-500	500	20.0	2.00	Green							
SMA-C-600	600	24.0	2.08	Blue							
SMA-C-750	750	30.0	2.12	Black							
SMA-C-1000	1000	40.0	2.32	Yellow							
SMA-C-1200	1200	48.0	2.20	Red							

(NOTE) The mentioned size and scale can be altered to improve the quality performance and capacity of the product without any notice.

## 2SMA

### Spring Mount

(Deflection : 25mm)

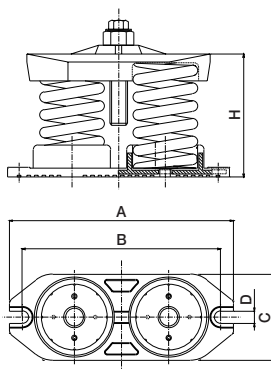

#### ● Features

Open spring mount is, in general, used together with an additional load base. Not only is it easy to install, but it also it a static deflection visible to the naked eye. It is excellent in reducing vibration with left-right and up-down stability. Its upper/bottom housings are made of castings with 2ea mounted springs. Because it is open-type, it can be used to reduce the vibrations that heavy equipment creates without having to use too many.

- Usage - For pumps (single-stage and multi-stage, turbine, double suction types)
- For air conditioning units (horizontal, vertical, hybrid, built-in, detachable, etc)
- For ventilators (sirocco, air-foil, turbo double suction and single suction types, etc)
- For all kinds of vibrating objects

#### ● Dimension & Selection Guide

Type	Capacity (kgf)	Spring Constant (kgf/mm)	Weight (kg)	Color	Dimension(mm)						
					A	B	C	D	H	Level Blot	Cap Screw
2SMA-1000	1,000	40.0	7.36	Green	252	223	97	14	162	M20×90	M12×25
2SMA-1200	1,200	48.0	7.52	Blue							
2SMA-1500	1,500	60.0	7.68	Black							
2SMA-2000	2,000	80.0	8.04	Yellow							
2SMA-2400	2,400	96.0	8.12	Red							

(NOTE) The mentioned size and scale can be altered to improve the quality performance and capacity of the product without any notice.